



**Morgans**

PROPERTY

21 David Crescent, Dunfermline, KY11 8HZ

Fixed Price £185,000









Stylish semi detached villa situated on enviable plot close to schooling and retail. This generous semi detached villa is well presented throughout and offered in move in condition. The accommodation briefly comprises entrance hall, W.C facilities, lounge and dining kitchen on the ground floor. On the upper level there are three bedrooms, modern and stylish en-suite and family bathroom. The property further benefits from patio doors to the fully enclosed rear garden providing a child and pet safe environment. The property has a double driveway, gas central heating and double glazed throughout.







## LOCATION

The ancient capital of Dunfermline won its bid to have official status city in May 2022, as part of the civic honour's competition to celebrate the Queen's platinum jubilee. The City of Dunfermline is of considerable historic interest and is the resting place of King Robert the Bruce. Carnegie's Birthplace museum, the Abbey and Abbot House reflect the historic interest of the city, whilst recent developments have seen Dunfermline move into the modern era with Carnegie Museum and Library. Dunfermline is located approximately five miles from the Forth bridges and is therefore particularly popular with commuters to Edinburgh and many parts of the central belt with easy access to the M90 motorway with its direct links to Edinburgh, Perth and Dundee and across the Kincardine Bridge by way of motorways to Stirling, Glasgow and the West. It benefits from a full range of shops, social and leisure facilities and educational establishments. The local railway stations provide a regular service to Edinburgh with intercity links to other parts of the UK. There are regular and convenient bus services both local and national.

## EXTRAS INC IN SALE / AGENTS NOTE

All floor coverings, blinds, bathroom and light fittings together with integrated appliances.

From 1st February 2022, residential properties in Scotland are required by law to have installed a system of inter-linked smoke alarms, carbon monoxide detectors and heat detectors (the "inter-linked system"). No warranty is given that any interlinked system has been installed in this property and interested parties should make their own enquiries. The owner will not warrant the working order of the fixtures and fittings or appliances which are included in the sale price.

















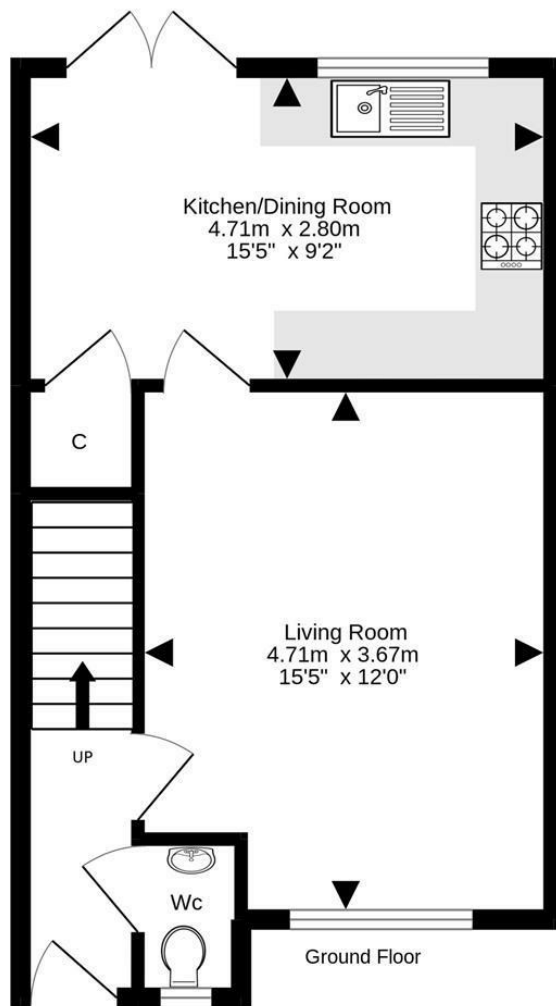

**Bathroom**  
1.89m x 1.70m  
6'2" x 5'7"

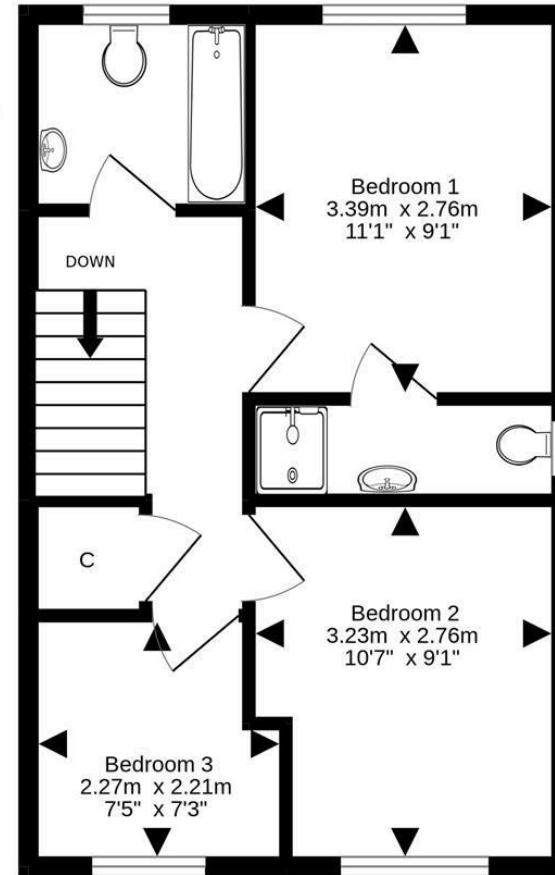

**Shower Room**  
2.80m x 0.90m  
9'2" x 2'11"

For details of the total internal floor area, please refer to the property's Home Report. This plan is for illustrative purposes only and should be used as such by a prospective purchaser.  
Made with Metropix ©2022



**SOLICITORS | PROPERTY**

**33 East Port, Dunfermline, Fife, KY12 7JE**

**Tel: 01383 620222 Fax: 01383 621213**

**[www.morganlaw.co.uk](http://www.morganlaw.co.uk)**



**espc**

**rightmove**

**Zoopla.co.uk**

**onTheMarket.com**

**s1homes.com**

**naeal propertymark**

**PROTECTED**

AGENTS NOTE These particulars do not form part of any contract and the statements or plans contained herein are not warranted nor to scale. Approximate measurements have been taken by electronic device at the widest point. Services and appliances have not been tested for efficiency or safety and no warranty is given as to their compliance with any Regulations. No movable items will be included in the sale.